

SPEAKER MOUNTING BRACKET YS-1100A

Thank you for purchasing TOA's Speaker Mounting Bracket.

Please carefully follow the instructions in this manual to ensure long, trouble-free use of your equipment.

1. SAFETY PRECAUTIONS

- Before installation or use, be sure to carefully read all the instructions in this section for correct and safe operation.
- Be sure to follow all the precautionary instructions in this section, which contain important warnings and/or cautions regarding safety.
- After reading, keep this manual handy for future reference.

Safety Symbol and Message Conventions

Safety symbols and messages described below are used in this manual to prevent bodily injury and property damage which could result from mishandling. Before operating your product, read this manual first and understand the safety symbols and messages so you are thoroughly aware of the potential safety hazards.

WARNING

Indicates a potentially hazardous situation which, if mishandled, could result in death or serious personal injury.

When Installing the Speaker

- Install the speaker only in a location that can structurally support the weight of the speaker and the mounting bracket. Doing otherwise may result in the speaker falling down and causing personal injury and/or property damage.
- Owing to the speaker's size and weight, be sure that at least two persons are available to install the speaker. Failure to do so could result in personal injury.
- Do not use other methods than specified to mount the bracket. Extreme force is applied to the speaker and the speaker could fall off, possibly resulting in personal injuries.
- Use nuts and bolts that are appropriate for the wall's structure and composition. Failure to do so may cause the speaker to fall, resulting in material damage and possible personal injury.

- Tighten each nut and bolt securely. Ensure that the bracket has no loose joints after installation to prevent accidents that could result in personal injury.
- Use the specified speaker in combination. Doing otherwise may cause the speaker or component to fall off, resulting in personal injury.
- Do not mount the speaker in locations exposed to constant vibration. The mounting bracket can be damaged by excessive vibration, potentially causing the speaker to fall, which could result in personal injury.
- Avoid installing the speaker in locations close to the seashore or in indoor swimming facilities that are not well ventilated. In such locations, the bracket may be vulnerable to corrosion, eventually allowing the speaker to fall resulting in personal injury.

CAUTION

Indicates a potentially hazardous situation which, if mishandled, could result in moderate or minor personal injury, and/or property damage.

When Installing the Speaker

- Avoid touching the speaker's sharp metal edge to prevent injury.

When the Speaker is in Use

- Do not place heavy objects on the speaker as this may cause it to fall or break which may result in personal injury and/or property damage. In addition, the object itself may fall off and cause injury and/or damage.
- Have the speaker checked periodically by the shop from where it was purchased. Failure to do so may result in corrosion or damage to the speaker or its mounting bracket that could cause the speaker to fall, possibly causing personal injury.

2. GENERAL DESCRIPTION

This is a bracket for attaching the HA series Long range array speaker to a wall.

The speaker can be adjusted from -45° to $+45^{\circ}$ to the left and right. This bracket comes in one set of 2 pieces.

3. INSTALLATION PRECAUTIONS

Speaker	Dedicated Brackets
HA-1030EN, HA-1060EN, HA-2120EN	1 set of YS-1100A (2 pieces per set). (2 of the same bracket used.)
HA-2240EN	2 sets of YS-1100A (2 pieces per set). (3 of the same bracket used. 1 piece unused.)

[HA-1030EN]

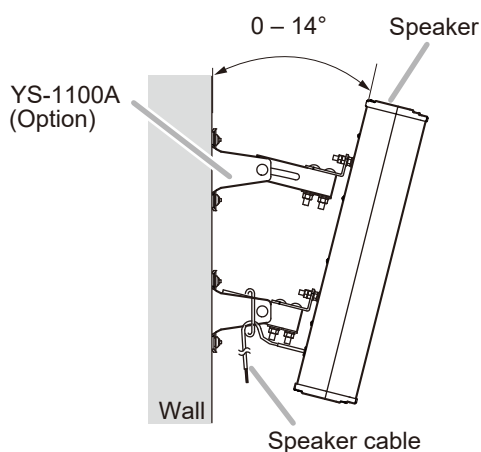

[HA-1060EN]

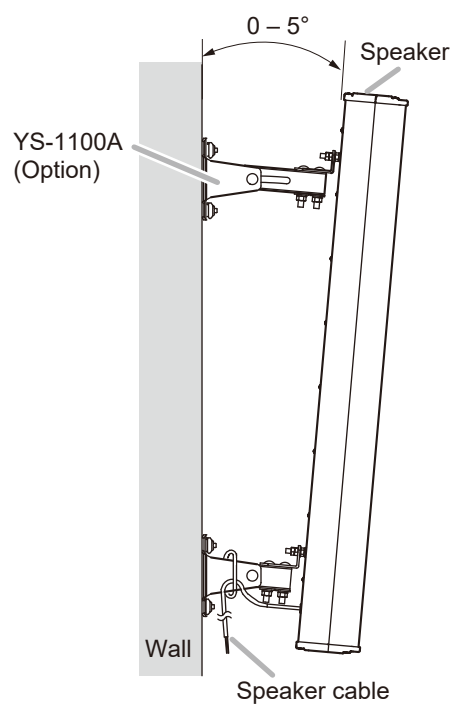

[HA-2120EN]

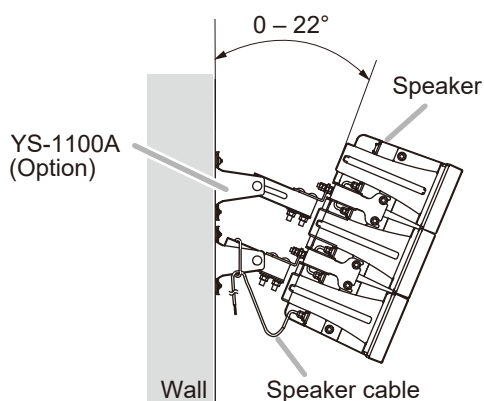

[HA-2240EN]

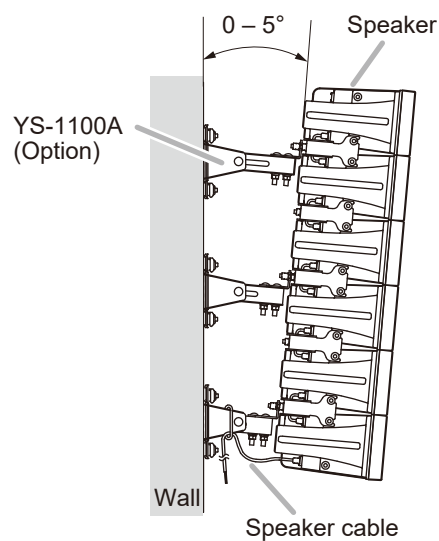

4. COMPOSITON OF THE BRACKET

The YS-1100A consists of Speaker and Wall brackets.

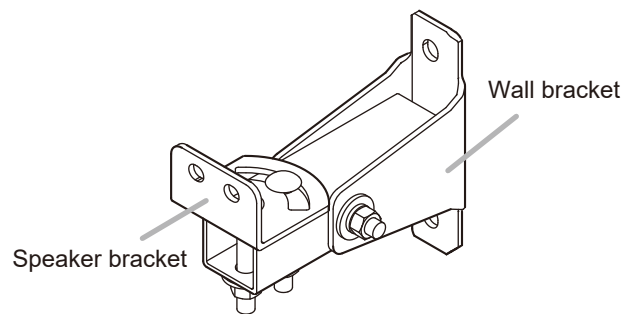

5. INSTALLATION

The attaching method is the same though each bracket's shape and size are different. This section provides an example of how to install the HA-1060EN.



WARNING

- Use safety wires when installing speakers. If not used, personal injury could result if a speaker should accidentally fall.
- Tighten the bolts securely, as instructed below. Failure to follow instructions precisely could result in a falling speaker and potential personal injury.
 - Ensure that all bolts are securely inserted as far as their threads go, then securely fasten each bolt with a nut.
 - Tighten all the bolts with the designated tightening torque. For tightening, use a Phillips screwdriver, or open- or box-end wrench.

Step 1. Remove the bolt on the brackets.

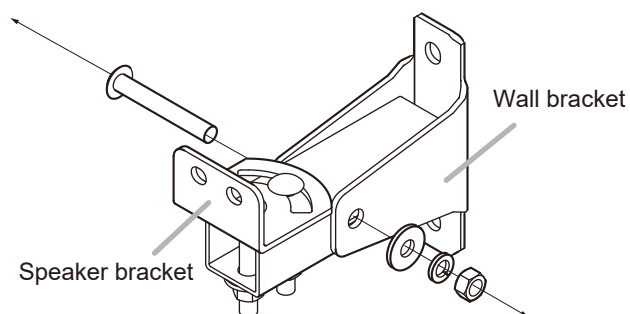

Step 2 Mount the Speaker bracket to the speaker.

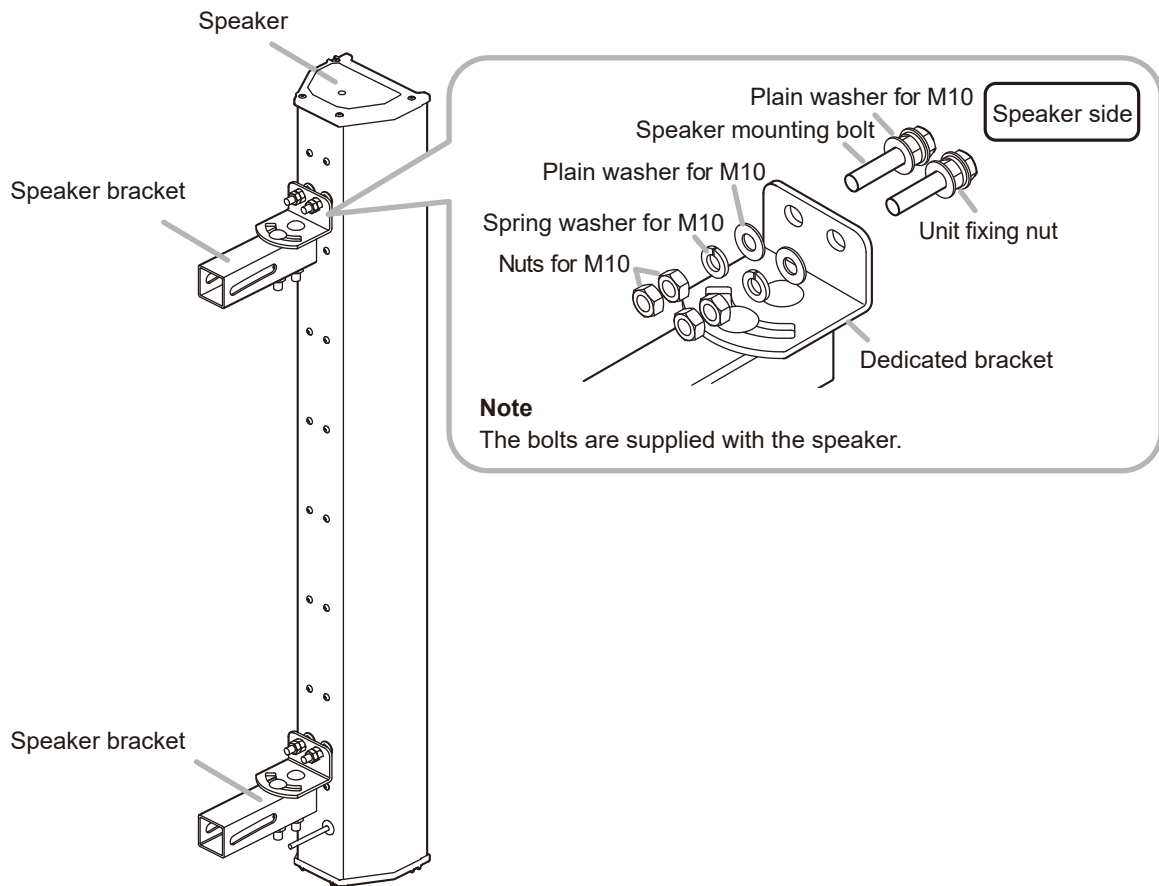

Step 3. Mount the Wall bracket to the wall.
Use at least 4 bolts (2 top, 2 bottom) to mount to the wall.

! WARNING

Bolts and nuts for mounting the bracket on the wall are not supplied. Use bolts and nuts that are appropriate for the wall's structure and composition. Failure to do so may cause the speaker to fall, resulting in material damage and possible personal injury.

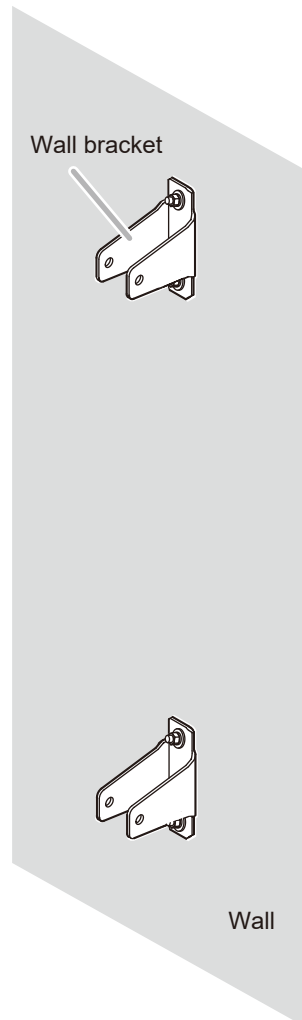

[Dimensional drawing of the wall bracket]

Note

Make sure that two of the uppermost and lowermost mounting holes indicated by the arrows are fixed to the wall with bolts, etc.

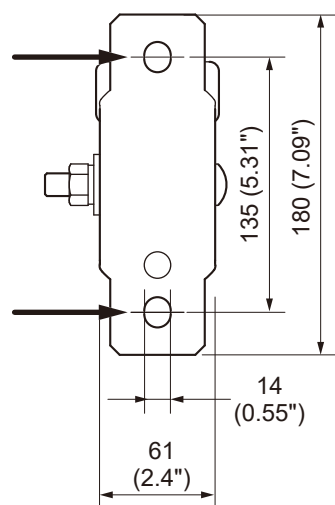

[HA-1030EN]

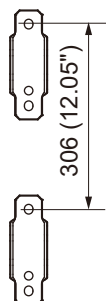

[HA-1060EN]



[HA-2120EN]

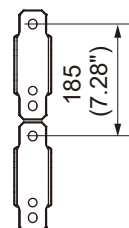

[HA-2240EN]

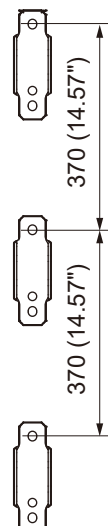

[Unit: mm]

Step 4. Temporarily fix the speaker to the Wall bracket.



WARNING

Be sure at least two people are employed to mount the speaker to the wall. If handled by only one person, the speaker could fall, potentially resulting in personal injury.

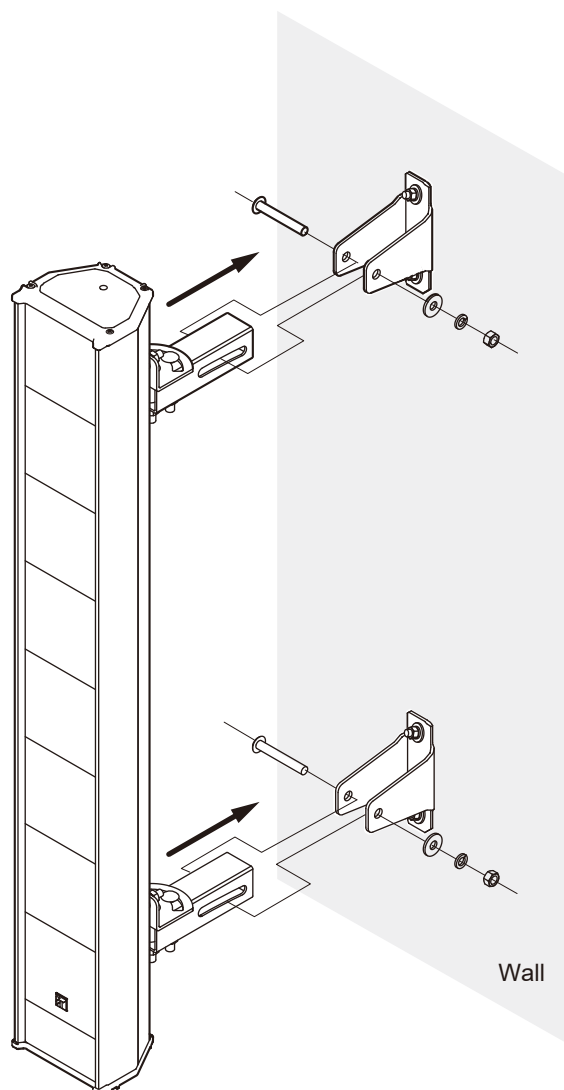

Step 5. Adjust the vertical angle of the speaker.
Loosen the 2 nuts and pull out the upper speaker bracket.
Adjust the angle, then tighten the nuts securely.

Recommended tightening torque: 39.2 N·m (400 kgf·cm)

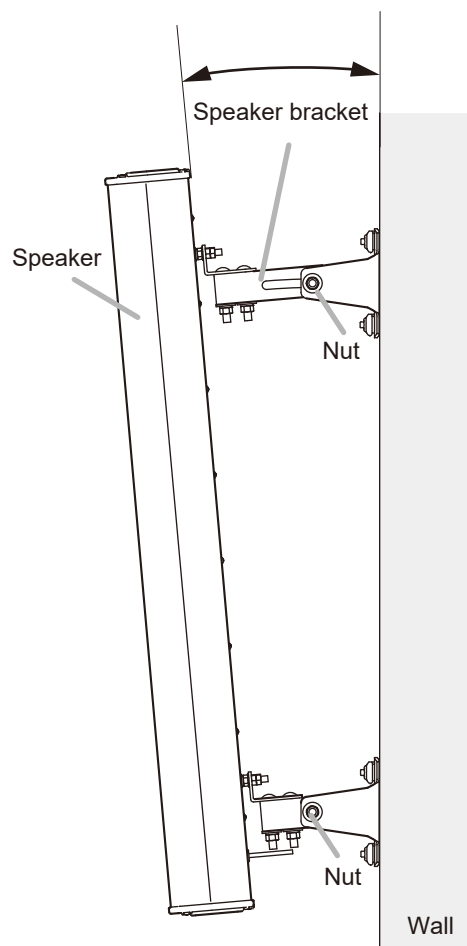

Step 6. Adjust the horizontal angle of the speaker.
Loosen the 4 nuts, then adjust the speaker brackets left and right. After adjusting the angle, tighten the nuts securely.

Recommended tightening torque: 39.2 N·m (400 kgf·cm)

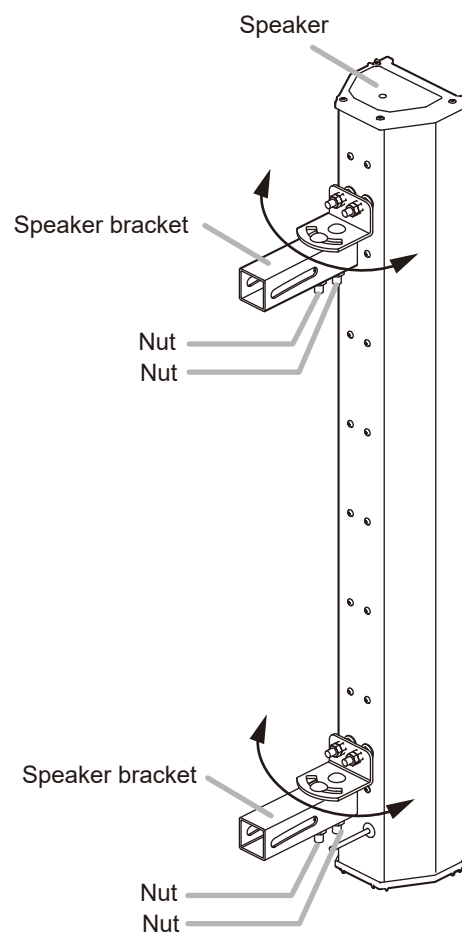
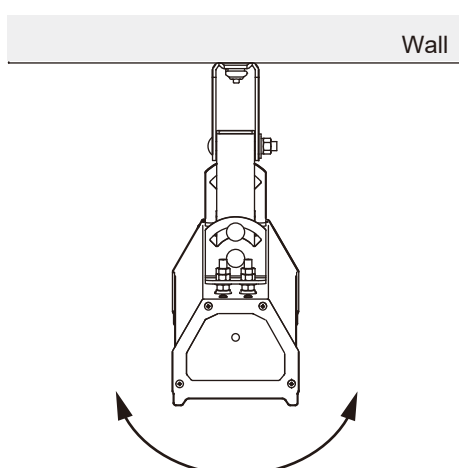

6. DIMENSIONAL DIAGRAM

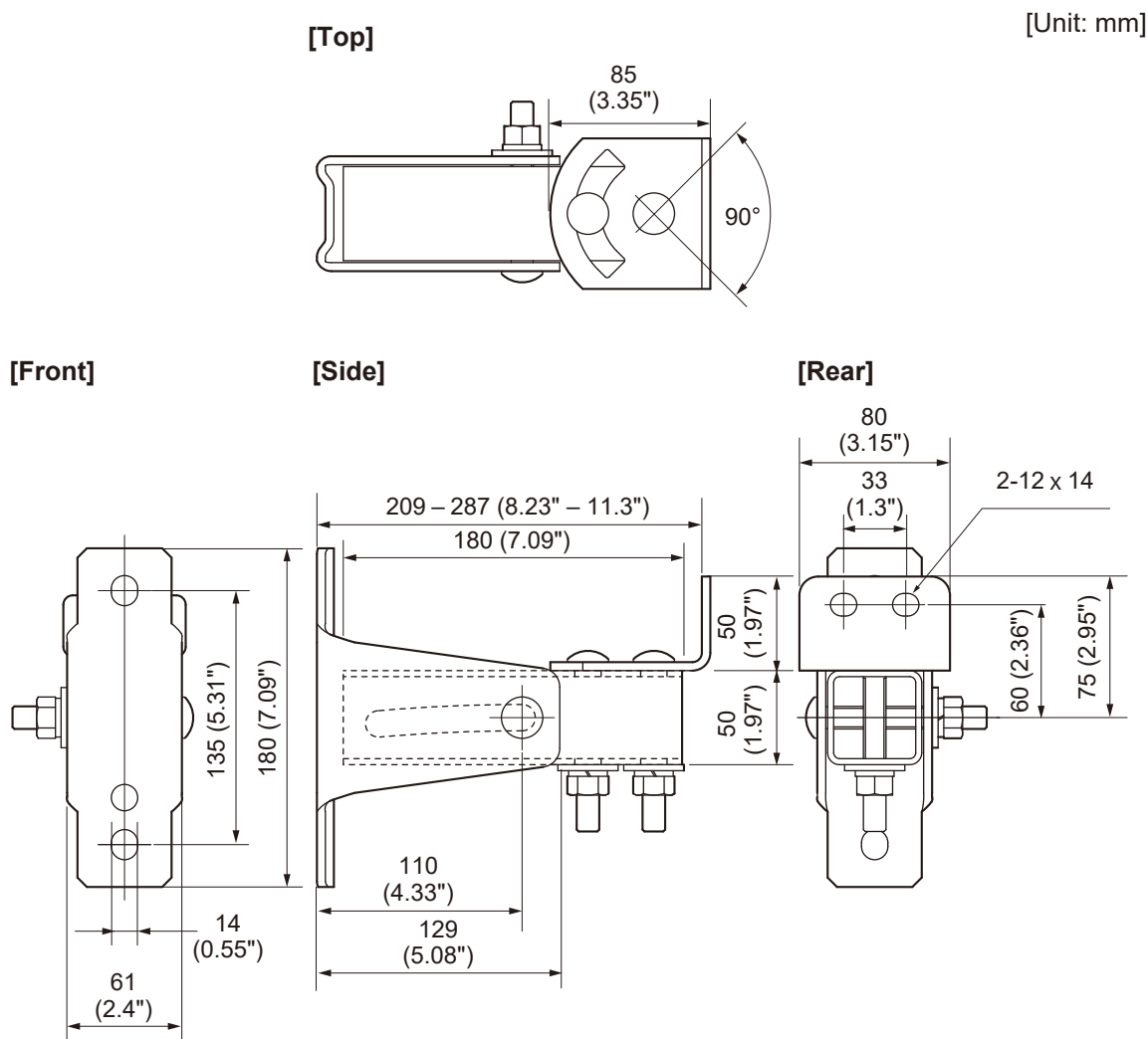

7. SPECIFICATIONS

Angular Adjustment	Horizontal: -45° to $+45^{\circ}$
Finish	Fixture: STKR400 t3.2 HZA*, SS400 t4.5 HZA* Bolt : SWRCH, HZA*
Weight	2.4 kg (5.29 lb) (per piece)
Applicable Speaker	HA-1030EN, HA-1060EN, HA-2120EN, HA-2240EN

* Hot-dip zinc-aluminium alloy galvanized coatings.

Note: The design and specifications are subject to change without notice for improvement.