

DESCRIPTION

The TOA Wireless Tuner Module WTU-4800 is a PLL-synthesizer controlled double superheterodyne diversity tuner module designed to be used in conjunction with UHF wireless equipment. It employs a compressor-expander system noise reduction circuit to minimize the influence of ambient RF noise.

SPECIFICATIONS

(\*1) 0 dB = 1 V

Power Requirement	7 - 12 V DC
Current Consumption	100 mA
Receiving Frequency	576 - 865 MHz (*2), UHF
Receiving System	Double super-heterodyne
Receiving Sensitivity	80 dB or more, Signal to Noise Ratio (20 dB $\mu$ V input, 40 kHz deviation)
Antenna Input Impedance	75 $\Omega$
Diversity System	Space diversity
Channel Selectable	16 channels
Squelch System	Noise SQ
Squelch Sensitivity	17 dB $\mu$ V
Output	0 dB (*1) (maximum deviation, 2.2 k $\Omega$ load)
Harmonic Distortion	1% or less
Frequency Response	100 Hz - 12 kHz, $\pm$ 3 dB
Operating Temperature	-10 $^{\circ}$ C to +50 $^{\circ}$ C (14 F $^{\circ}$ to 122 F $^{\circ}$ )
Operating Humidity	30 % to 85 %RH (no condensation)
Finish	Surface-treated steel plate
Dimensions	60 (W) $\times$ 25 (H) $\times$ 139 (D) mm (2.36" $\times$ 0.98" $\times$ 5.47")
Weight	130 g (0.29 lb)
Accessory	Driver for channel changing.....1

APPEARANCE

Rear View

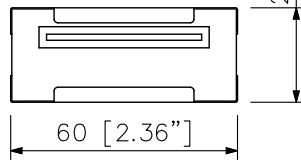

Top View

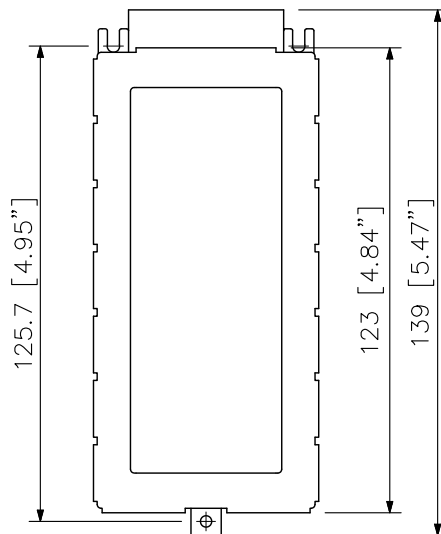

Front View

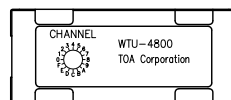

Side View

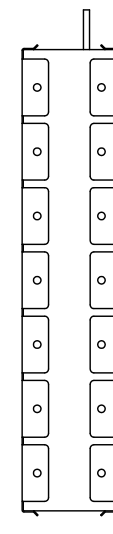

(\*2)

Type	Receiving Frequency
A01	692 - 722 MHz, UHF
B01, B02	722 - 752 MHz, UHF
C01 - C07	794 - 830 MHz, UHF
D01 - D05	830 - 865 MHz, UHF
E01	668 - 698 MHz, UHF
F01	636 - 666 MHz, UHF
G01, G02	606 - 636 MHz, UHF
H01	576 - 606 MHz, UHF

UNIT: mm SCALE: 1/2